

# 18" PE BOLTED MANWAY W/13.5" ACCESS

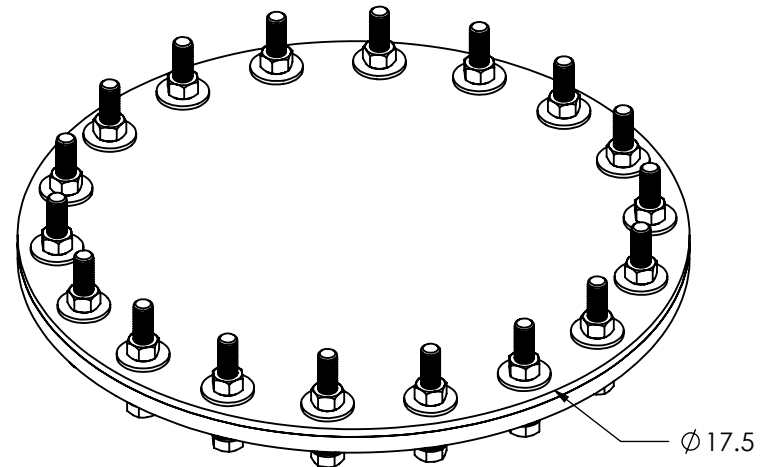
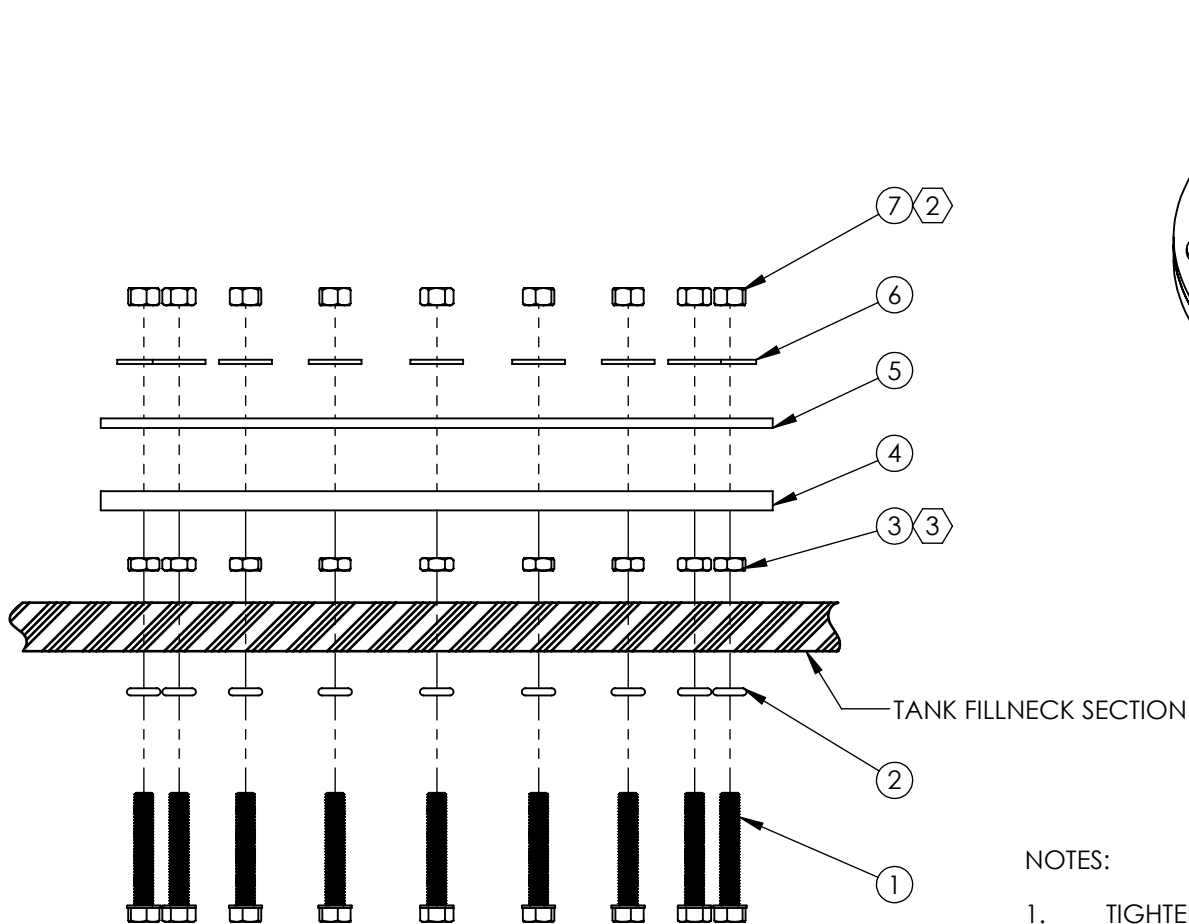

### NOTES:

1. TIGHTEN NUTS BY HAND WITH A NUT DRIVER AS SPECIFIED. DO NOT OVER-TIGHTEN SINCE STRIPPING WILL RESULT.
2. TIGHTEN 3 TURNS AFTER CONTACT WITH FLAT WASHER.
3. TIGHTEN 1.25 TURNS AFTER CONTACT WITH TANK, 10 IN.-LBS. MAX.

ITEM NO.	QTY.	PART NUMBER	DESCRIPTION
7	18	35100100	NUT 1/2-13 CT PP #MHX1500-13-113
6	18	35100229	WASHER 1/2 X 1 X 1/16IN FLAT PVC
5	1	35900589	LID PE 18IN MANWAY SEALED
4	1	33100214	GASKET PE 18IN SEALED MANWAY
3	18	35100099	NUT 1/2-13 JAM CT PP #MHX1400-13-113
2	18	33100132	O-RING VITON 1/2 X .875 70D
1	18	34300099	BOLT PP 1/2-13X3 CT #J131-30-113

DO NOT SCALE		DRAWN BY	DATE		TITLE:	REVISION
Released		SB	02/05/2014		MANWAY PE 18IN SEALED	A
© SNYDER INDUSTRIES INC., 2014				4700 Fremont Street Lincoln, NE 68504 (402) 467-5221 www.snyder.net.com	PART NO.	ENG. ID.
ALL DIMENSIONS, DESIGNS, AND INFORMATION ON THIS PRINT MUST BE CONSIDERED PROPRIETARY TO SNYDER INDUSTRIES, INC. AND MAY NOT BE USED, COPIED, OR DISTRIBUTED WITHOUT WRITTEN PERMISSION OF AN OFFICER (OR HIS AGENT) OF THE FIRM.					34701134	D001567

**\*ALL EXTERNAL PIPING MUST BE INDEPENDENTLY SUPPORTED.**  
**\*ONLY BASE FITTINGS TO BE LEFT INSTALLED AT TIME OF SHIPMENT PER SII PROCEDURE.**  
**\*Consult Snyder's Guidelines for Use and Installation prior to delivery.**  
 Available on-line at <http://www.snyderindustriestanks.com/Technical>  
**ALL DIMENSIONS ARE IN INCHES, NOMINAL, & SUBJECT TO CHANGE WITHOUT NOTICE.**  
**ALL DIMENSIONS ON ROTATIONAL MOLDED PARTS ARE SUBJECT TO A ± 3% TOLERANCE.**